

Hardware Included:

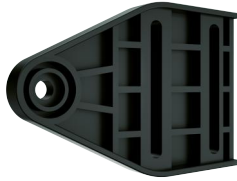

Flex Fence End Buckle

x1



Lag Screw

x1

Step 1

Determining End Buckle Locations

Pilot holes must be drilled first. To do this, use a fence bracket as a guide and mark the center point for pilot hole locations as shown. Using a 3/8" drill bit, drill pilot holes for all End Buckle locations.

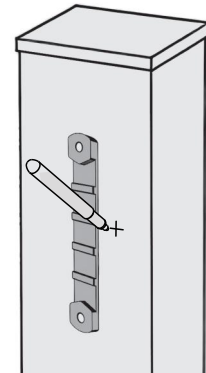

Step 2

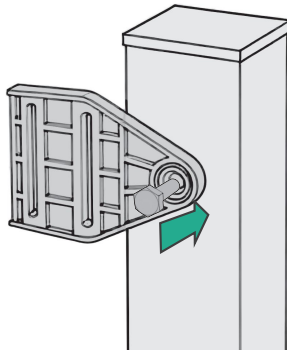

Install Fence End Buckle

Attach the End Buckle to the post using the supplied lag screw .

Step 3

Install and fasten Flexible Rail

Let flexible rail pass bottom hole, bent it, let it pass front hole and fasten it.

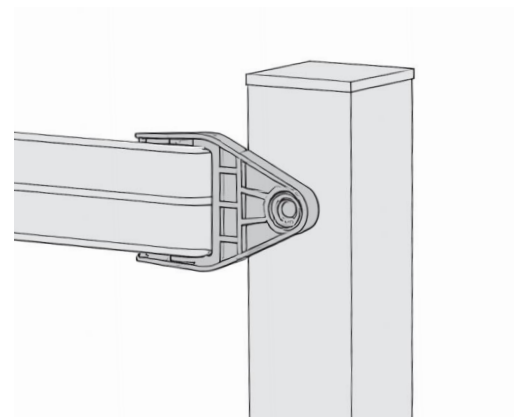

Hardware Included:

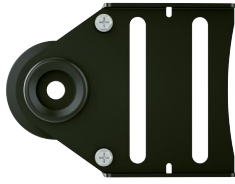

Flex Fence End Buckle

x1



Lag Screw

x1

Step 1

Determining End Buckle Locations

Pilot holes must be drilled first. To do this, use a fence bracket as a guide and mark the center point for pilot hole locations as shown. Using a 3/8" drill bit, drill pilot holes for all End Buckle locations.

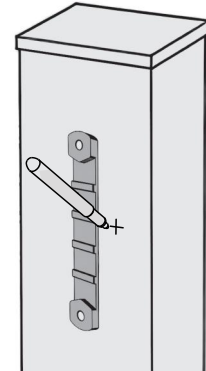

Step 2

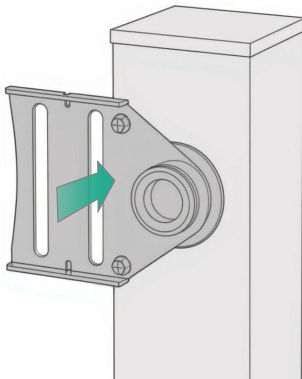

Install Fence End Buckle

Attach the End Buckle to the post using the supplied lag screw.

Step 3

Install and fasten Flexible Rail

Let flexible rail pass bottom hole, bent it, let it pass front hole and fasten it.

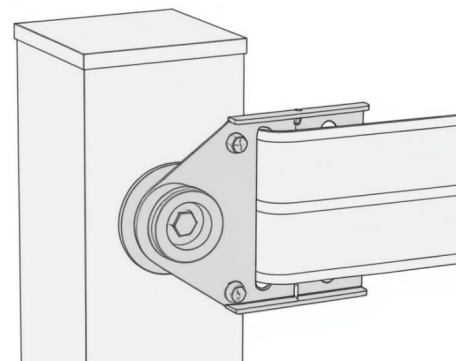

**Hardware
Included:**



Rail Tensioner

x1

Step 1

Remove accessory

Remove 2 pins and 1 baffle from Rail Tensioner.

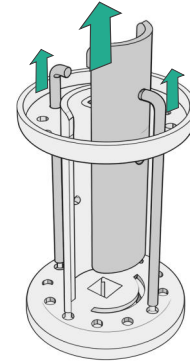

Step 2

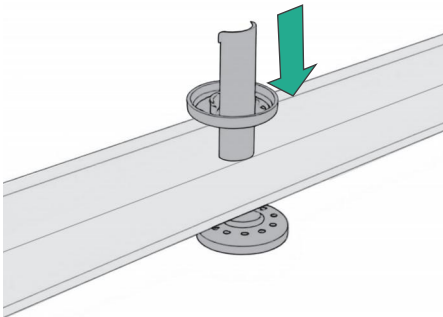

Install Rail Tensioner

Attach Rail Tensioner to the flexible rail and fasten it by baffle.

Step 3

Finish Installation

Tighten the flexible rail and fasten it by 2 pins.

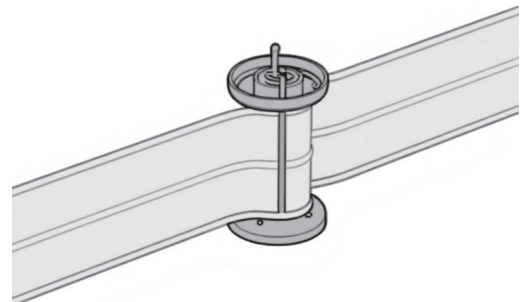

Hardware Included:



Flex Fence Splice Plate

x1



Lag Screw

x2



washer

x6

Step 1

Install Flex Fence Splice Plate

Let 2 flexible rails go through holes of Flex Fence Splice Plate and bent them.

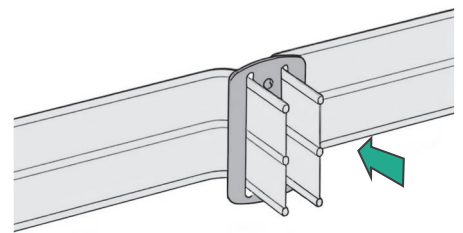

Step 2

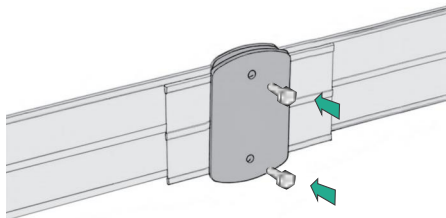

Finish Installation

Attach Splice Plate to 2 flexible rails using the supplied lag screws and washers.

Hardware Included:



Two-Way Barrel Tensioner

x1



Lag Screw x1

Step 1

Determining Two-Way Barrel Tensioner Locations

Pilot holes must be drilled first. To do this, use a fence bracket as a guide and mark the center point for pilot hole locations as shown. Using a 3/8" drill bit, drill pilot holes for all Two-Way Barrel Tensioner locations.

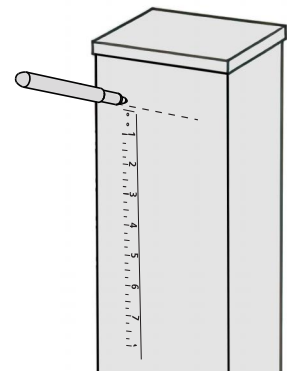

Step 2

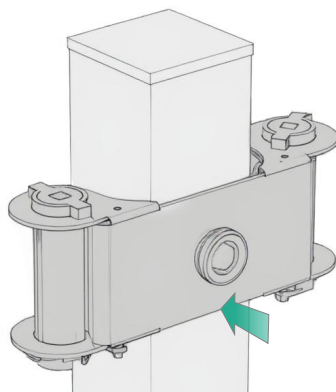

Install Two-Way Barrel Tensioner

Attach the Two-Way Barrel Tensioner to the post using the supplied lag screw and washer.

Step 3

Finish Installation

Drive Lag screws through post to fix the Two-Way Barrel Tensioner.

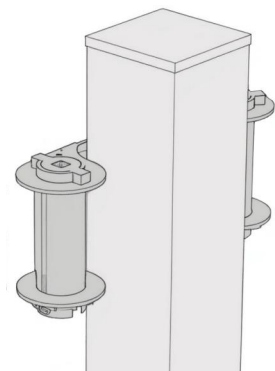

Step 4

Install roller

Insert the Flexible Rail into hole of Barrel Tensioner and tighten it as your request.

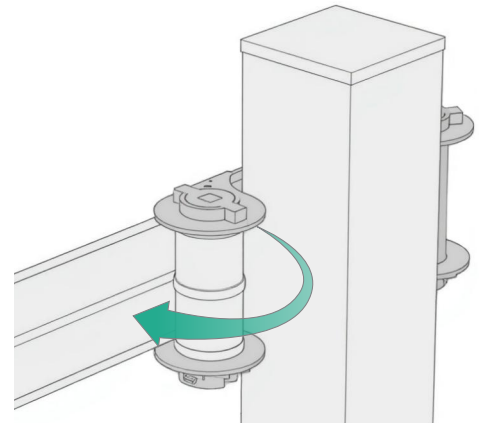

Step 5

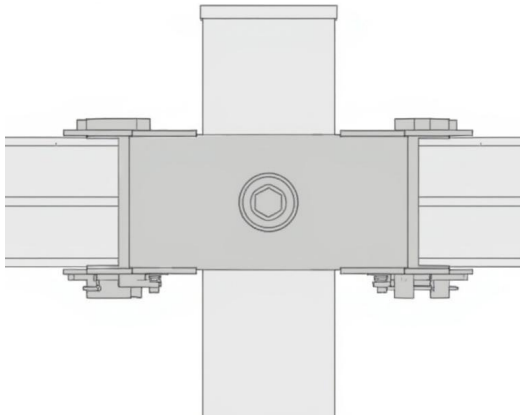

Finish Installation

Complete installation on the other side.

Hardware Included:



Rail Brackets

x1



Lag Screw

x2

Step 1

Determining Rail Bracket Locations

Pilot holes must be drilled first. To do this, use a fence bracket as a guide and mark the center point for pilot hole locations as shown. Using a 3/8" drill bit, drill pilot holes for all Termination Bracket locations.

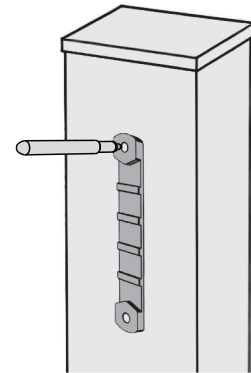

Step 2

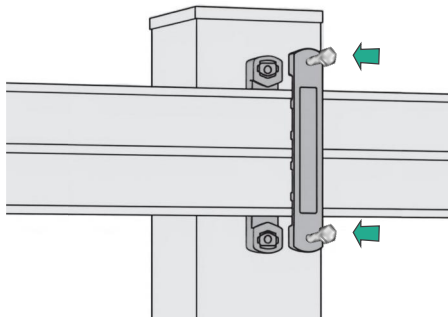

Install Rail Bracket

Attach the Rail Bracket to the post using the supplied lag screw.

Step 3

Installing The Rest Rail Brackets

After finishing, installing the rest Rail Brackets with Flexible Rail.

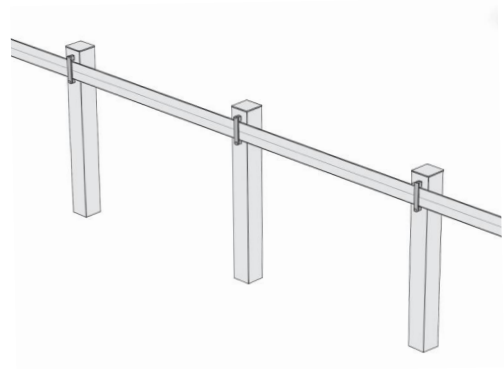

Hardware Included:



Rail Side Bracket

x1



Lag Screw

x2

Step 1

Determining Rail Bracket Locations

Pilot holes must be drilled first. To do this, use a fence bracket as a guide and mark the center point for pilot hole locations as shown. Using a 3/8" drill bit, drill pilot holes for all Termination Bracket locations.

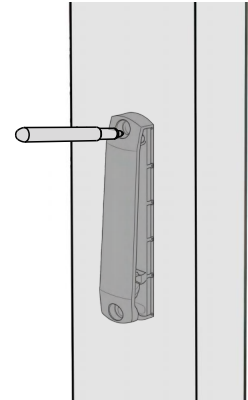

Step 2

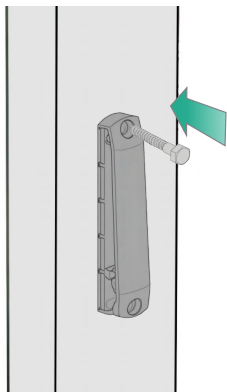

Install Rail Bracket

Attach top side of Rail Side Bracket to the post using the supplied lag screw.

Step 3

Installing The Rest Rail Brackets

Attach flexible rail inside Rail Side Bracket, fix bottom side of Bracket by using the supplied lag screw.

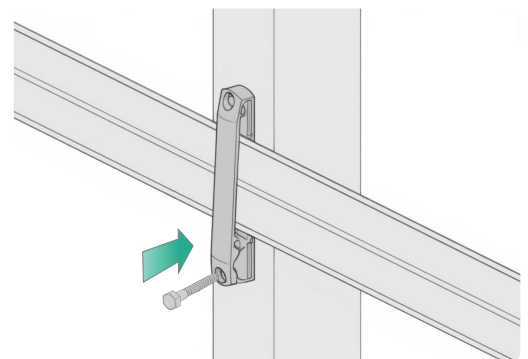

Hardware Included:



One-Way Barrel Tensioner

x1



Lag Screw x1

Step 1

Determining One-Way Barrel Tensioner Locations

Pilot holes must be drilled first. To do this, use a fence bracket as a guide and mark the center point for pilot hole locations as shown. Using a 3/8" drill bit, drill pilot holes for all One-Way Barrel Tensioner locations.

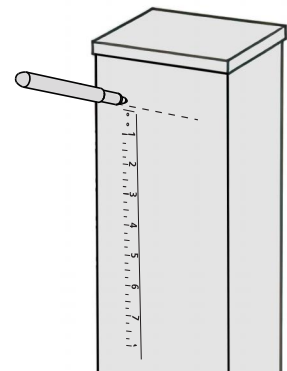

Step 2

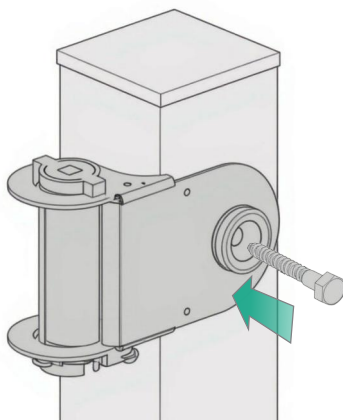

Install One-Way Barrel Tensioner

Attach One-Way Barrel Tensioner to post using supplied board, grommet, lag screws and washers.

Step 3

Finish Installation

Insert the Flexible Rail into hole of Barrel Tensioner and tighten it.

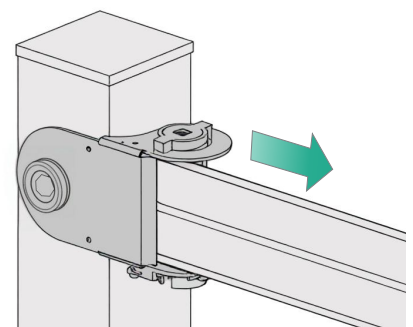

Hardware Included:



Inside
Corner roller

x1



Lag Screw x2



nut x2



washer x2

Step 1

Determining Corner roller Locations

Pilot holes must be drilled first. To do this, use a metal frame as a guide and mark the center point for pilot hole locations as shown. Using a 3/8" drill bit, drill pilot holes for all Inside Corner roller locations.

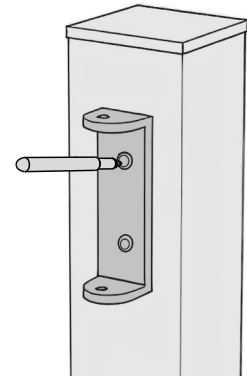

Step 2

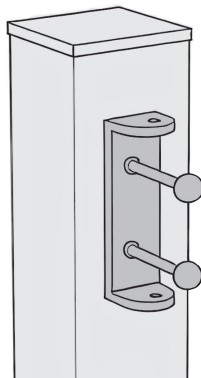

Install Corner roller

Attach the Corner roller to the post using the supplied lag screw and washer.

Step 3

Fix Corner roller

Drive Lag screws through post to fix the Inside Corner roller.

